



RESPONSE - REQUEST FOR QUALIFICATIONS

NEW HIGH SCHOOL | HEBER UTAH
WASATCH COUNTY SCHOOL DISTRICT

ATTENTION: WCSD PURCHASING / DECEMBER 01, 2022







BUILDING THE WESTLAND WAY

Higher Level Construction Management



SECTION 1 | FIRM EXPERIENCE & QUALIFICATIONS

After more than 42 years working in the tile, stucco, drywall, and fireproofing industry, Westland Construction was formed by Stanley A. Houghton, Jr. in 1992.

On average, we complete more than \$400 million of construction each year, with key projects in K-12 & Higher Education, Sports & Recreation, Retail & Commercial, Medical & Industrial, Multi-Family and Religious structures.

OUR EXPERIENCE

With 20 years of education construction experience, *Westland has emerged as the preferred Education Construction Manager in Utah.* With us, you get the knowledge and insight of an experienced team that specializes in robust K-12 projects. Our team's expertise will translate into safe, effective management of the project in a manner that prioritizes quality, schedule and budget control.

OUR OFFICES

Westland's home office, warehouse, and equipment yard are based in Orem, Utah. Our Southwest office, located in St. George, UT, has grown to become the largest commercial CM/GC in Southern Utah. We have a vested interest in serving and adding value to the communities where we conduct business.

OUR CAPACITY

Westland employs more than 200 full-time construction professionals, with an office staff of 50, supporting seven estimators, 15 project managers and 30 superintendents. We have the qualified workforce to get the job done.

OUR SERVICES

Westland offers a wide variety of construction-related services, including Preconstruction Consulting, General Contracting, Construction Management, Design-Build, and Construction Consulting Services. We obtain contracts through the competitive bid process and on a negotiated basis; in fact, 85 percent of our work is on a negotiated basis. This indicates to us that *we are delivering construction services that exceed our client's expectations.*

OUR COVERAGE

Westland is licensed in Utah, Alaska, Arizona, Arkansas, California, Colorado, Hawaii, Illinois, Idaho, Oregon, Nevada, New Mexico, Montana, North Dakota, Tennessee, Texas, Washington, Wyoming, and for the Governments of New Zealand, Fiji, Samoa, Tonga, Haiti, and Kinshasa DR Congo.

OUR FINANCIAL STABILITY

Westland operates debt-free, has substantial cash reserves, and has an *excellent bonding capacity of \$950 million* to ensure that your project will be built with ease. Arch Specialty Insurance Company issues our bonding through Moreton & Company in Salt Lake City. Never in our company's history has our bonding company, or any surety, had to finish a project or pay a claim for us.

OUR TRACK RECORD

Our team is proud to say that we have never failed to complete any project work that we have been awarded. We uphold a commitment to excellence with every project, no matter the size, which has always ensured that each of our projects is completed on time and within budget.

OUR EDUCATION FOCUS

Twenty years ago, Westland Construction set a goal to become a leader in the education construction industry, and we never looked back. We have been able to meet that goal by maintaining transparency and communication through every stage of a project, while providing innovative and budget-conscious solutions that meet the changing requirements of Utah's School Districts.

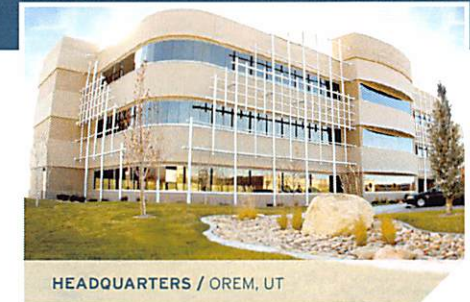

HEADQUARTERS / OREM, UT



SOUTHWEST OFFICE / ST. GEORGE, UT

BUSINESS TYPE | Corporation founded in 1992

PRIMARY CONTACTS

Chris Houghton, CEO | 801-404-0384 mobile
chris@westlandconstruction.com

Kyle Houghton, President | 801-404-0476 mobile
kyle@westlandconstruction.com

Todd Houghton, VP Southwest & Canada | 435-703-0137 mobile
todd@westlandconstruction.com

FIRM EXPERIENCE & QUALIFICATIONS

Over the past two decades, Westland Construction has completed more than 200 education facility projects. Our K-12 experience ranges from small upgrades and improvements to \$150M+ replacements. With Westland Construction, you can be confident that you've chosen a highly-qualified partner that will help you get the best facility possible for your money.

OUR EDUCATION CLIENTS

- Wasatch School District
- Provo School District
- Alpine School District
- Canyons School District
- Carbon School District
- Morgan School District
- Daggett School District
- Juab School District
- Granite School District
- Uintah School District
- Nebo School District
- Davis School District
- San Juan School District
- Duchesne School District
- Washington School District
- Jordan School District

OUR PEOPLE

We are school builders; that's what we do best. As a company, we bring a team that has demonstrated construction experience, building hundreds of new K-12 school projects and other significant replacement/rebuild/addition/remodel projects. Our company has an exceptional track record of delivering our education projects on-time or ahead of schedule, and within or under the construction budget.

Started as a family business, Westland was founded on old-fashioned values. We operate with honesty and integrity, and we haven't forgotten our roots. While our ability to offer a full-range of preconstruction and construction services is unparalleled; what truly sets us apart is our people. *With Westland as your General Contractor, you get large-company capabilities with small-company service, quality, and attention to detail.*

OUR COMMITMENT TO QUALITY & SAFETY

Westland has a fully-integrated quality culture. Like our careful approach to safety, the commitment to quality on Westland projects stands equally as high. All Westland employees and trades personnel are provided the training and resources to produce stellar results. More than a program, ours is a collaborative approach focused on identifying and eliminating potential issues, so the quality standards achieved on each and every Westland project are truly "Quality Without Question."

Westland's commitment to quality is led by our full-time Safety Director, Aaron Daley. Aaron will develop a Site Specific Quality Plan (SSQP) tailored specifically to your project. As part of the SSQP, the following activities are planned and will be completed on your project:

- Submittals & Shop Drawings
- Inspection Management
- Commissioning
- Pre-Installation Meetings
- 12-Month Warranty Walk
- Close Out & Turnover



VIEWPOINT MIDDLE SCHOOL | LEHI UTAH

VCBO IS PLEASED TO RECOMMEND WESTLAND CONSTRUCTION

As a Principal/Owner at VCBO Architecture, LLC, I have had the opportunity to oversee teams responsible for delivering highly complex and challenging projects. This experience has allowed me the opportunity to interface with numerous clients and local, regional, and international contractors. The success of each of these projects hinges on the relationship between the Owner, Architect, and Contractor as we attempt to balance cost, scope, and quality in a manner consistent with the Owner's project expectations. When I think of successful project experiences, Westland Construction comes to mind. My experience working with Westland Construction on challenging projects with multiple complexities has more than exceeded my expectations.

Since 2011, VCBO has worked alongside Westland on over a dozen projects. Our collaborations have included a variety of unique facilities, ranging from healthcare to K-12. Many of our projects have required unique expertise and knowledge, particularly when it comes to longevity and durability. Along the way, Westland has repeatedly proven that they possess the experience necessary to take on complex projects.

Vern Latham, AIA | Principle/Partner | VCBO Architects

VCBO
ARCHITECTURE



Chris A. Houghton | CEO



Kyle A. Houghton | President

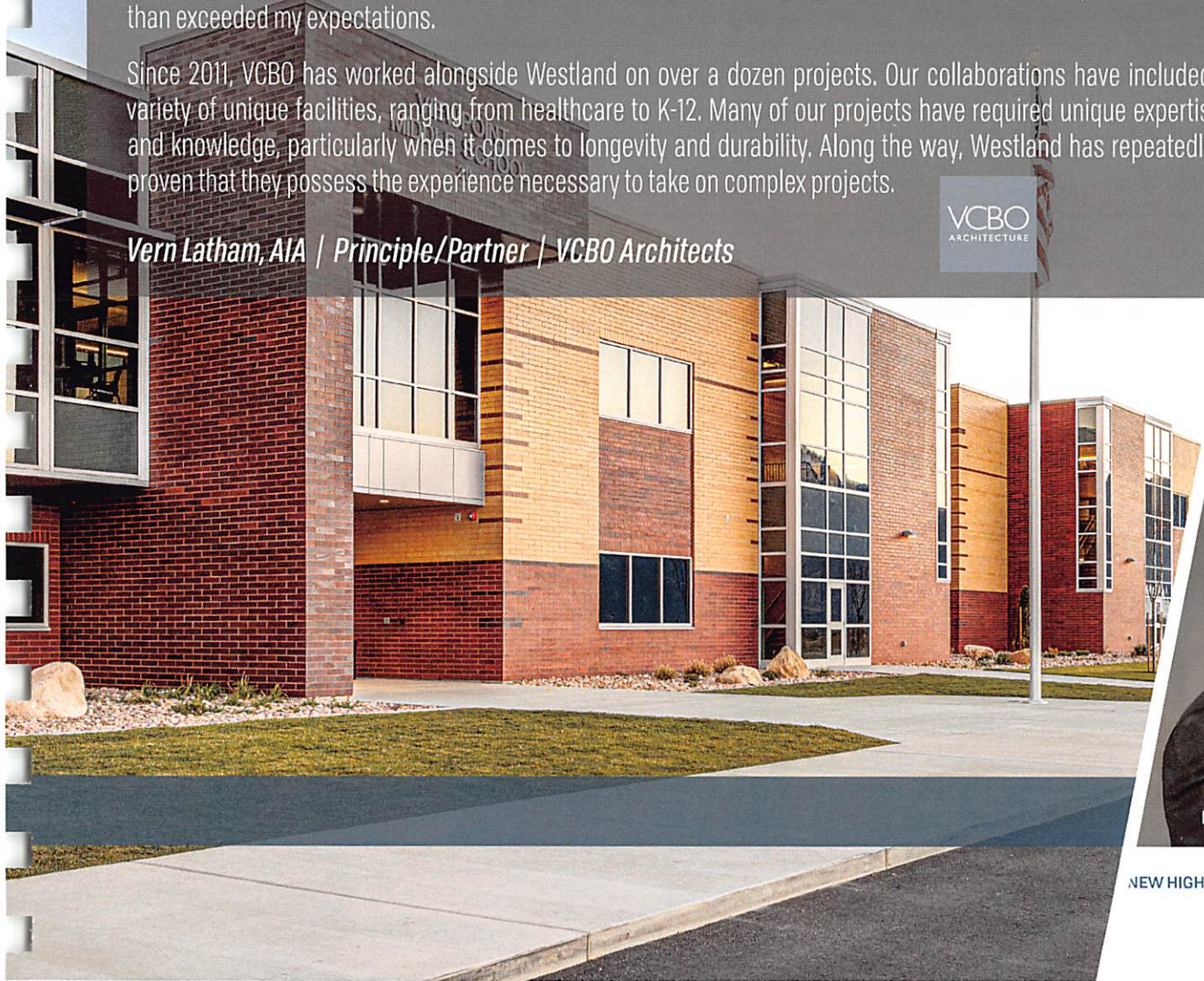

FIRM EXPERIENCE & QUALIFICATIONS

AVAILABILITY OF PROJECT TEAM

Our proposed Project Team of seasoned construction professionals are excited to join another Davis School District project. Each team member is eager to begin work on this project. All personnel proposed are available at the preliminary start date(s) to begin work, and our current, and expected, workload will not impact our ability to fulfill our contract.

STANDARD SCHOOL QUALIFICATION REQUIREMENTS

These requirements are common among school district's requests for qualification:

YES	Do you have a minimum of eight (8) years of public school construction experience? <i>Westland has 15+ years of public school construction experience.</i>
YES	If yes, do you have experience building in a currently occupied school building? <i>Over 85% of our school projects have been completed on "active campus" sites.</i>
YES	Can you secure bonding for a project of this size? <i>Westland has ample bonding capacity, with \$950 million aggregate available.</i>
YES	Have constructed buildings under Utah Code 53A-3-413? <i>Utah Code 53A-3-413 is a typical requirement of our education facility projects.</i>
YES	Have constructed a public school building of at least \$5,000,000 in value? <i>On average, our public school projects are over \$30,000,000 per project.</i>



Using our unique, proprietary "Graphic Scheduling" and "Units in Place" project management methods, Westland was able to complete the new 79,000 square foot Springside Elementary School in under 7 months... The ONLY education Construction Manager in the State of Utah to accomplish this.

Quality, Schedule, and Budget were maintained and met.



UTAH CONSTRUCTION & DESIGN

2022 MOST OUTSTANDING PROJECT

LARGE K-12 EDUCATION

HILLCREST HIGH SCHOOL ACTIVE-SITE REBUILD | MIDVALE, UTAH





SECTION 2 | CONTRACTOR TEAM



CHRIS HOUGHTON
Executive Sponsor

PRE CONSTRUCTION AND COST ESTIMATING



MARK PETERSEN
Director
Education Construction

CONSTRUCTION AND SUPPORT



TRENT HUNTSMAN
SCOTT DAVIES
Project Manager
(OPTIONS)



SETH KING
JIM EALEY
Project Superintendent



ALLEN LAINHART
Preconstruction
Cost Estimator



TYSON BLATTER
BIM/Modeling



CHARLEY ALGER
Project Logistics
& Scheduler



TRENT HUNTSMAN
SCOTT DAVIES
Project Manager
(OPTIONS)



SETH KING
JIM EALEY
Project Superintendent



BRAD STEELE
BEN FOOTE
Project Engineer



CHARLEY ALGER
Project Logistics
& Scheduler



AARON DALEY
Safety Director

UNIQUELY QUALIFIED

The Westland Construction Team and support staff have extensive experience in planning and construction of Utah's largest and newest K-12 schools.

Our commitment to excellence, combined with the most up-to-date construction management technology, a skilled staff and Westland's exclusive construction management methodology, Graphic Scheduling, in preconstruction and construction, allow us to provide an ideally qualified team for construction of the *New WCSD High School Heber project*.

QUALITY PERSONNEL

Westland is an employee-owned company where a culture of excellence is the standard. This is an asset to our clients. Employee owners recognize the importance of continuous improvement and innovation. Our culture and procedures are geared to foster innovation and quality.

When you own a piece of the company, there is stronger bond, sense of responsibility, and motivation to provide stellar service. We empower and reward Westland employees to ensure a job is done well.



KEY PROJECT TEAM MEMBERS

CHRIS HOUGHTON

CHIEF EXECUTIVE OFFICER

Chris has been with Westland Construction for over 30 years working in a myriad of positions from laborer to CEO. Chris has always had a passion for construction, which started at a very young age while working on his first projects with his father, uncle, and grandfather at around 9 years old. He also had the opportunity to help with the project management of Westland Construction's first international project in Apia, Samoa in 2003.

His knowledge of industry practices and processes is unmatched because of his experience. Under his leadership, Westland has developed and grown in an unprecedented manner. He has been instrumental in revenue growth from \$125 M in 2015 to a projected \$425 M in 2022 revenue.

No other construction executive in the State knows K-12 construction better than Chris.

PROJECT EXPERIENCE *Partial Listing*

WASATCH COUNTY SCHOOL DISTRICT AQUATIC CENTER
New Construction | \$12M | 37,000 sf

NEW CYPRUS HIGH SCHOOL
New Construction | \$125M | 500,000 sf

HILLCREST HIGH SCHOOL
Rebuild | \$113M | 430,000 sf

MOUNTAIN VIEW HIGH SCHOOL
New Construction | \$80M | 400,000 sf

LEHI HIGH SCHOOL
Rebuild | \$50M | 300,000 sf

PROVO HIGH SCHOOL
New Construction | \$72M | 350,000 sf

UNION HIGH SCHOOL
New Construction | \$75M | 350,000 sf

VALLEY VIEW MIDDLE SCHOOL
New Construction | \$35M | 142,000 sf

VIEWPOINT MIDDLE SCHOOL
New Construction | \$50M | 116,000 sf

NOORDA COLLEGE OF OSTEOPATHIC MEDICINE
New Construction | \$90M | 160,000 sf

BYU WEST VIEW ADMINISTRATIVE BUILDING
New Construction | \$12M | 51,000 sf

THE ASCENT PARK CITY
New Construction | \$45M | 120 Studio & 1-Bedroom Units

UINTAH BASIN MEDICAL CENTER - VERNAL MOB
New Construction | \$20M | 46,000 sf

UINTAH BASIN MEDICAL CENTER HOSPITAL
Renovation & Addition | \$17M | 30,200 sf

AUCKLAND NEW ZEALAND LDS TEMPLE
New Construction | 35,000 sf

REVERE HEALTH MULTI-SPECIALTY CLINIC - SPANISH FORK
New Construction & Adaptive Re-use | \$18M | 90,000 sf

INTERMOUNTAIN HEALTH CARE MEDICAL CLINIC WEST JORDAN
Addition & Remodel | \$3.5M | 20,000 sf

MEADOWBROOK ELEMENTARY SCHOOL
New Construction | \$18M | 100,000 sf

CAREER SUMMARY

28 Years with Westland
30 Years of experience

2000-2009 | Director Operations

2009-2017 | Vice President

2017-Present | CEO

Snow College

Lost Arts Building Trades

Instructor/Trainer 1995-1999

Consulting and Mentoring for UVU, BYU
& all local Colleges for Construction
Management programs 2009-Current

EDUCATION

UVU Construction Management
1993-1995

PROFESSIONAL CERTIFICATIONS

Licensed Commercial Contractor

+32 Domestic States

+12 Countries



KEY PROJECT TEAM MEMBERS

MARK PETERSEN

PROJECT DIRECTOR

For more than two decades, Mark has played a crucial role in Westland's success. He is a perceptive leader, exceptional communicator, and keen problem solver. He is often tasked with some of our most challenging K-12 projects, based on his dedication, insight, and expertise.

As Project Director, Mark collaborates with the team to provide a clear picture of project costs and deliverables and is exceptionally knowledgeable in all aspects of K-12 projects. Mark is detail-oriented and committed to excellence in all aspects of his duties. From start to finish, he is invested in your project's success.

CAREER SUMMARY

22 Years with Westland

22 Years of experience

EDUCATION

Utah Valley University

B.S. General Studies

PROFESSIONAL CERTIFICATIONS

OSHA 10-Hour Training

Primavera Scheduling Certificate

PROJECT AWARDS

UC&D's 2021 Most Outstanding Project

Lehi High School Rebuild

PROJECT EXPERIENCE *Partial listing*

CYPRUS HIGH SCHOOL

New Construction | \$168M | 500,000 sf

LEHI HIGH SCHOOL

Rebuild | \$50M | 300,000 sf

WASATCH COUNTY AQUATIC CENTER

New Construction | \$12M | 37,000 sf

UNION HIGH SCHOOL

New Construction | \$75M | 350,000 sf

ALTAMONT HIGH SCHOOL

Addition & Renovation | \$22M | 105,000 sf

TRAILSIDE ELEMENTARY SCHOOL

New Construction | \$20M | 80,000 sf

SILVER LAKE ELEMENTARY SCHOOL

New Construction | \$21M | 83,000 sf

POLARIS HIGH SCHOOL WEST

Remodel | \$624,000

VIEWPOINT MIDDLE SCHOOL

New Construction | \$50M | 116,000 sf

CASCADE ELEMENTARY SCHOOL

New Construction | \$19M | 84,000 sf

BELMONT ELEMENTARY SCHOOL

New Construction | \$16M | 80,000 sf

LIBERTY HILLS ELEMENTARY SCHOOL

New Construction | \$18M | 84,000 sf

BROOKHAVEN ELEMENTARY SCHOOL

New Construction | \$16M | 80,000 sf

ROOSEVELT AQUATIC CENTER

New Construction | \$8.4M | 29,000 sf

OREM JUNIOR HIGH SCHOOL

Addition | \$5M | 25,500 sf

KINGS PEAK ELEMENTARY SCHOOL

Addition & Mechanical Upgrades | \$4.5M | 20,000 sf



KEY PROJECT TEAM MEMBERS

TRENT HUNTSMAN

SENIOR PROJECT MANAGER

Throughout his 28 years of experience in the construction industry, Trent has developed a broad skill set, with the ability to work with any client on any project. Trent has been with Westland for over two decades, and has been a key team member on many significant projects over the years. Trent sets himself apart as an exceptional Project Manager in several ways, most notably with his ability to stay calm in stressful situations and make strategic and tactical project decisions.

As Project Manager, Trent will be the point of contact for key decision-making and management of the project. He will work closely with the architect, engineers, and consultants to complete the project according to plans, specifications, and bidding documents. He will oversee critical details such as schedule, budget, forecasting, safety, and general project requirements. His excellent organizational, management, and communication skills will be a valuable asset to your project.

There is no other Project Manager in the State that understands K-12 construction better.

CAREER SUMMARY

23 Years with Westland

28 Years of experience

EDUCATION

College of Eastern Utah

B.S. General Studies

PROFESSIONAL CERTIFICATIONS

- Primavera Scheduling Certificate
- ICE 2000 Certification
- OSHA 10 Hour Training

PROJECT EXPERIENCE *Partial listing*

HILLCREST HIGH SCHOOL

Rebuild | \$114M | 430,000 sf

EMERY HIGH SCHOOL

Rebuild | \$40M | 175,000 sf

MOUNTAIN RIDGE HIGH SCHOOL

New Construction | \$77M | 391,000 sf

PROVO HIGH SCHOOL

New Construction | \$75M | 361,000 sf

RICHFIELD HIGH SCHOOL

Rebuild | \$35M | 225,000 sf

SPRINGSIDE ELEMENTARY SCHOOL

New Construction | \$18M | 79,000 sf

Owner-Accelerated 7-month project completion

CHERRY HILL ELEMENTARY SCHOOL

Rebuild | \$10M | 52,000 sf

DRY CREEK ELEMENTARY SCHOOL

New Construction | \$14.5M | 78,000 sf

MIDVALE ELEMENTARY SCHOOL

New Construction | \$15M | 86,000 sf

RIVER ROCK ELEMENTARY SCHOOL

New Construction | \$13M | 85,000 sf

RED CLIFFS ELEMENTARY SCHOOL

New Construction | \$14M | 73,500 sf

SUNSET VIEW ELEMENTARY SCHOOL

Renovation | \$12.5M | 87,000 sf

ROCK CANYON ELEMENTARY SCHOOL

Renovation | \$12.5M | 87,000 sf

WESTMORE ELEMENTARY SCHOOL

Rebuild | \$9M | 62,000 sf

PLEASANT GROVE HIGH SCHOOL FIELDHOUSE

Addition | \$14M | 61,000 sf

BROOKSIDE ELEMENTARY SCHOOL

Renovation & Addition | \$10M | 70,000 sf



KEY PROJECT TEAM MEMBERS

SCOTT DAVIES

PROJECT MANAGER

Scott brings over 21 years of experience in the construction industry to the Westland team. As a project manager, quality control manager, and close-out specialist, Scott has gained valuable knowledge, an acute attention to detail, and the ability to manage high-dollar, complex projects efficiently and effectively.

As project manager, Scott will oversee document control, close-out management, and value engineering. Other roles will include constructibility review, pre-installation meetings, mock-up coordination, and oversight of quality assurance. Scott has experience working with multiple school districts and will be an excellent addition to your team.

CAREER SUMMARY

<1 Year with Westland
21 Years of experience

EDUCATION

Brigham Young University
M.S. Construction Management
California State University - Fresno
B.S. Psychology

PROFESSIONAL CERTIFICATIONS

- OSHA 30-Hour Training
- Tilt-up Concrete Association Technician
- Utah Certified SWPPP Inspector
- Certified Environmental Control

PROJECT EXPERIENCE *Partial listing, Some projects listed were completed prior to employment with Westland*

LOGAN HIGH SCHOOL
Renovation

KAY'S CREEK ELEMENTARY SCHOOL
New Construction

OLD MILL ELEMENTARY SCHOOL
New Construction

EDGEMONT ELEMENTARY SCHOOL
New Construction | 70,000 sf

CRIMSON MIDDLE SCHOOL
Tilt-up Construction | 350,000 sf

MIDVALE MIDDLE SCHOOL
New Construction

TELOS UNIVERSITY FACILITY
Tilt-up Construction | \$13.13M | 125,000 sf

HEALTH EQUITY BUILDING 3
New Construction | \$12M | 120,000 sf

UTAH COUNTY ACADEMY OF SCIENCES
Expansion

MOUNTAIN WEST TRUCK
Tilt-up Construction | \$8.5M | 80,000 sf

W.W. CLYDE OFFICE
Tilt-up Construction

LEHI CITY POWER PLANT
Tilt-up Construction | \$12.9M | 70,000 sf

RIVERFRONT MEDICAL CENTER
Tilt-up Construction | \$7M | 90,000 sf

SIGNATURE TRUCKING
Tilt-up Construction | 50,000 sf

WHEELER MACHINERY
Tilt-up Construction | 200,000 sf

BAKER BUILDING
Tilt-up Construction | 40,000 sf

BARNEY TRUCKING
Tilt-up Construction | 70,000 sf

PAPARAZZI ACCESSORIES
Renovation | 60,000 sf



KEY PROJECT TEAM MEMBERS

SETH KING PROJECT SUPERINTENDENT

Seth is an experienced leader. As former vice president and co-founder of two multi-million dollar companies, he is well-versed in the careful management of people, budgets, and schedules. He got his foundation in the construction industry as a carpenter after completing his career as a professional baseball player and coach and has worked his way up through the ranks, managing several multi-million dollar projects.

As superintendent, Seth will ensure that your project maintains the highest level of quality, while remaining cost effective and on schedule. He is collaborative and skilled at ensuring each interested party is represented and understood throughout the construction process. He will be an excellent addition to your project.

CAREER SUMMARY

<1 Year with Westland
20 Years of experience

EDUCATION

Brigham Young University
B.S. Construction Management

PROFESSIONAL CERTIFICATIONS

- OSHA 30-Hour Training

PROJECT EXPERIENCE *Partial listing, Some projects listed were completed prior to employment with Westland*

TIMPVIEW HIGH SCHOOL
Rebuild | \$65M | 325,000 sf

UNIVERSITY OF UTAH - NEUROPSYCHIATRIC INSTITUTE
Addition | \$45M

CITY CREEK - SALT LAKE CITY, UTAH
New Construction | \$750M



KEY PROJECT TEAM MEMBERS

JIM EALEY PROJECT SUPERINTENDENT

A carpenter by trade, Jim is one of Westland’s most seasoned superintendents; bringing 28 years of construction supervisory experience to this project. Jim collaborates will with architects and owners, and is dedicated to finding solutions that suit all stakeholders. His ability to supervise and communicate with subcontractors, while focusing on quality and project safety, make him a top asset.

As superintendent, Jim will oversee, coordinate, supervise and inspect all field construction. His proven experience and ability will compliment those of the proposed management team. His duties also include chairing and conducting weekly subcontractor progress meetings, equipment start-up, final inspections, owner instructions, building occupancy and coordination and supervision of pre-punch and punch list activities.

CAREER SUMMARY

18 Years with Westland
28 Years of experience

EDUCATION

Utah Valley University
B.S. General Studies

COMMUNITY SERVICE

- 27 Years EMS
- 20 Years Fire-Fighting

PROFESSIONAL CERTIFICATIONS

State of Utah
Registered SWPPP Inspector (RSI)

PROJECT EXPERIENCE *Partial listing*

NOORDA COLLEGE OF OSTEOPATHIC MEDICINE
New Construction | \$125M | 300,000 sf

LEHI HIGH SCHOOL
Rebuild | \$50M | 300,000 sf

CASCADE ELEMENTARY SCHOOL
New Construction | \$19.4M | 84,000 sf

PROVO HIGH SCHOOL
New Construction | \$72M | 350,000 sf

RICHFIELD HIGH SCHOOL
Replacement | \$35M | 207,000 sf

RED CLIFFS ELEMENTARY SCHOOL
New Construction | \$14M | 73,500 sf

EAGLE VIEW ELEMENTARY SCHOOL
Replacement | \$13.5M | 88,000 sf

SIERRA BONITA ELEMENTARY SCHOOL
New Construction | \$12M | 84,000 sf

DUCHESNE ELEMENTARY SCHOOL
New Construction | \$12M | 81,500 sf

WESTMORE ELEMENTARY SCHOOL
Replacement | \$9M | 62,000 sf

MEADOW ELEMENTARY SCHOOL
Addition | \$4M | 21,000 sf

NEBO VIEW ELEMENTARY SCHOOL
Addition | \$3.6M | 46,000 sf

SYRACUSE ELEMENTARY SCHOOL
Addition | \$3.2M | 12,200 sf

MONA ELEMENTARY SCHOOL
Addition | \$3M | 20,000 sf

LYMAN ADMINISTRATION BUILDING
New Construction | \$2.2M | 10,000 sf

SALEM CITY RECREATION FACILITY
New Construction | \$890K | 3,700 sf

SPRINGVILLE DESERET INDUSTRIES
New Construction | \$4.5M | 54,000 sf

ROCKY MOUNTAIN ATV
Warehouse Addition | \$4.6M | 100,000 sf



KEY PROJECT TEAM MEMBERS

BRAD STEELE PROJECT ENGINEER

With over 15 years working with various subcontractors, Brad brings valuable experience to the Project Engineer team. As a Project Engineer, Brad will be heavily involved in the RFI and Submittal processes as well as coordination with subcontractors. With his background in installation and skilled labor, he is well equipped for these roles. He is proficient in all necessary construction softwares such as Viewpoint and Bluebeam as well as skilled in drafting the reading and interpretation of building plans. He will be an excellent addition to your team.

CAREER SUMMARY

6.5 Years with Westland
15.5 Years of experience

EDUCATION

Utah Valley University
B.S. Technology Management
Utah Valley University
A.A.S. Building Construction

Fluent in Spanish

PROFESSIONAL CERTIFICATIONS

- RMGA Certified
- EPA Certified (Type I & II)

PROJECT EXPERIENCE *Partial listing, Some projects listed were completed prior to employment with Westland*

HILLCREST HIGH SCHOOL
Rebuild | \$1.4M | 28,000 sf

TOOELE WAREHOUSE 649
Renovation | \$3.5M | 89,492 sf

PROVO HIGH SCHOOL
Rebuild | \$75M | 349,735 sf

HERITAGE HALLS - BYU
Payson Sheet Metal - Balanced Water & Air Systems

PROVO CITY CENTER TEMPLE
Payson Sheet Metal - Balanced Water & Air Systems



CAREER SUMMARY

2 Years with Westland

6 Years of experience

KEY PROJECT TEAM MEMBERS

BEN FOOTE PROJECT ENGINEER

Ben brings a dedicated work ethic to lead to the Westland team. Starting as a Project Engineer with Westland, Ben has proven his value to the most complicated projects. His ability assisting PM's and Superintendents to manage the details and sequencing of a project, coupled with strong inter-personal skills, makes him a positive addition to any construction project team.

Ben has 6 years of construction-management experience ranging from engineering and design to new construction in commercial, and religious projects . As a PE, Ben excels in managing project details from the early stages of conceptual design through planning and construction, working together with Owners, design professionals and project-related personnel on coordination, scheduling, and implementation of the project details in order to build a successful project.

PROJECT EXPERIENCE Partial listing

OREM UTAH TEMPLE

New Construction | 70,000 sf

VERNON ELEMENTARY SCHOOL

On-site Replacement | 30,000 sf

BLOCKYARD INDUSTRIAL COMPLEX

New Construction

GRANITE LIBRARY

New Construction | 31,000 sf

ALTA HIGH SCHOOL PAC

New Construction | 63,000 sf



KEY PROJECT TEAM MEMBERS

ALLEN LAINHART PRECONSTRUCTION & COST ESTIMATING

Though a recent addition to the Westland Team, Allen is a seasoned estimator with multi-faceted experience in the construction industry.

Beginning his career as an architect, Allen has developed a keen eye for detail and a high level of professionalism. His experience includes managing teams, producing construction documents, coordinating with Owners and Contractors, and reviewing and approving schedules and payment requests. His skills developed as an architect have only been amplified as an estimator, as he understands the importance of accurate information in every detail, clear communication with all involved parties, and has a strong drive towards an on time and in budget, quality final product.

CAREER SUMMARY

1 Year with Westland
26 Years of experience

EDUCATION

Western Governors University
B.S. Business Management

ITT Technical Institute
A.S. Computer Drafting

College of the Desert
A.S. Agricultural Business

PROFESSIONAL AFFILIATIONS

AIA Utah
Uniform Drafting System Cert

KINDERCARE

New Construction | \$3.1M | 13,500 sf

KINDERCARE

New Construction | \$2.3M | 12,000 sf

VALLEY STATION MEDICAL OFFICE BUILDING

New Construction | \$3M | 16,000 sf

SOUTH PASTURE MEDICAL OFFICE BUILDING

New Construction | \$3.2M | 16,600 sf

ROY MEDICAL OFFICE BUILDING

New Construction | \$2.1M | 10,000 sf

WASHINGTON STREET APARTMENTS

New Construction | \$10.8M | 69,500 sf

THE POINTE CONDOMINIUMS

New Construction | \$13.8M | 58,500 sf

EAST BAY APARTMENTS

New Construction | \$71M | 465,000 sf

SUNSET TOWNHOMES

New Construction | \$3M | 22,600 sf

CAL RANCH

TI Remodel | \$2.1M | 62,000 sf

WAGNER RETAIL CENTER

New Construction | \$3.1M | 19,000 sf

LOT 8 BUSINESS EXCHANGE PARK - CORE & SHELL

New Construction | \$5.8M | 78,000 sf

UNIVERSITY FEDERAL CREDIT UNION

New Construction | \$2M | 2,900 sf

HILL AIRFORCE BASE MILITARY HOUSING

New Construction | \$1.1M | 7,000 sf



KEY PROJECT TEAM MEMBERS

TYSON BLATTER VDC/BIM MANAGER

Tyson leads WEstland Construction's in-house BIM efforts, specializing in developing models and providing data-driven solutions to Westland's clients and project teams. He is highly skilled and experienced in Virtual Design and Construction (VDC) and Building Information Modeling (BIM) and facilitates the integration of BIM to effectively manage various preconstruction and construction projects. Tyson's role includes defining a BIM strategy, implementing systems for communication and data exchange, monitoring the process for potential improvement, and implementing best practices for designing, developing, delivering, and maintaining successful projects.

With a bachelor's degree in Mechanical Engineering, Tyson understands the complex nature of the AEC industry and the evolving challenges facing our clients and teams. He is a highly collaborative, strategic, and communicative leader dedicated to providing the best digital technology tools and resources for your project.

CAREER SUMMARY

3 Years with Westland

6 Years of experience

EDUCATION

Brigham Young University - Idaho

B.S. Mechanical Engineering

PROJECT EXPERIENCE *Partial listing*

AUCKLAND NEW ZEALAND LDS TEMPLE

New Construction | 35,000 sf

HAMILTON NEW ZEALAND LDS TEMPLE

New Construction | 22,000 sf

PROVO UTAH LDS TEMPLE
Renovation | 150,130 sf

EPHRAIM UTAH LDS TEMPLE

New Construction | 38,623 sf

TORREON MEXICO LDS TEMPLE

New Construction | 10,125 sf

QUERETARO MEXICO LDS TEMPLE

New Construction | 27,530 sf

NEIAFU TONGA LDS TEMPLE

New Construction | 16,678 sf

PAGO PAGO SAMOA LDS TEMPLE

New Construction | 16,678 sf

OREM UTAH LDS TEMPLE

New Construction | 74,342 sf

SAN PEDRO SULA HONDURAS LDS TEMPLE

New Construction | 38,457 sf

ST. GEORGE UTAH LDS TEMPLE

Renovation | 142,000 sf

PRAIA CAPE VERDE LDS TEMPLE

New Construction | 11,700 sf

BYU WEST VIEW ADMINISTRATIVE BUILDING

New Construction | \$10M | 50,460 sf

SPANISH FORK CITY LIBRARY & ADMIN BUILDING

New Construction | \$18.5M | 44,000 sf

TIMPVIEW HIGH SCHOOL

Replacement | \$65M | 325,000 sf

VALLEY VIEW MIDDLE SCHOOL

New Construction | \$35M | 142,000 sf



KEY PROJECT TEAM MEMBERS

CHARLEY ALGER

PROJECT SCHEDULER

Charley is a valued member of the Westland team. With 15 years of experience, his background in project management gives him the keen eye needed to ensure timely delivery of quality projects to our clients. He is a self-motivated leader whose excellent communication skills and strong work ethic earn the respect and trust of clients and associates alike.

Charley is responsible for assessing and managing project requirements and resources to ensure all Westland project work is completed on time. He creates comprehensive timetables for all projects, determining the timing of tasks and materials needed to accomplish the project according to plans and specifications. Charley has worked as a Project Manager, Owner's Representative, QC/Field Engineer, Project Engineer, and Superintendent throughout his career in the construction industry. This experience helps him build accurate and dynamic schedules for Westland's projects.

CAREER SUMMARY

3 Years with Westland
15 Years of experience

EDUCATION

Weber State University
B.S. Construction Management

PROFESSIONAL CERTIFICATIONS

- OSHA 30 Hour Safety Training
- American Institute of Constructors

PROJECT EXPERIENCE *Partial listing*

ST. GEORGE UTAH TEMPLE
Major Historic Remodel | 142,000 sf

INTERMOUNTAIN HEALTH CARE LEHI MOB
New Construction | \$22M | 17,000 sf

EPHRAIM UTAH TEMPLE
New Construction | 39,000 sq ft

INTERMOUNTAIN HEALTH CARE - SARATOGA SPRINGS
Remodel/Expansion | \$20M | 17,000 sf

HAMILTON NEW ZEALAND TEMPLE
Renovation & Seismic Upgrade | 44,000 sf

CITY CREEK SHOPPING MALL
New Construction

AUCKLAND NEW ZEALAND TEMPLE
New Construction | 35,000 sf

DATA CENTER @ CAMP WILLIAMS
New Construction | \$2B | 240 acre site

SAN PEDRO SULA HONDURAS TEMPLE
New Construction | 70,000 sf

SALT LAKE CITY UTAH TEMPLE
Remodel | 120,000 sf

OREM UTAH TEMPLE
New Construction | 70,000 sf

REVERE HEALTH MOB - SALEM, UTAH
New Construction | \$16.5M | 90,000 sf

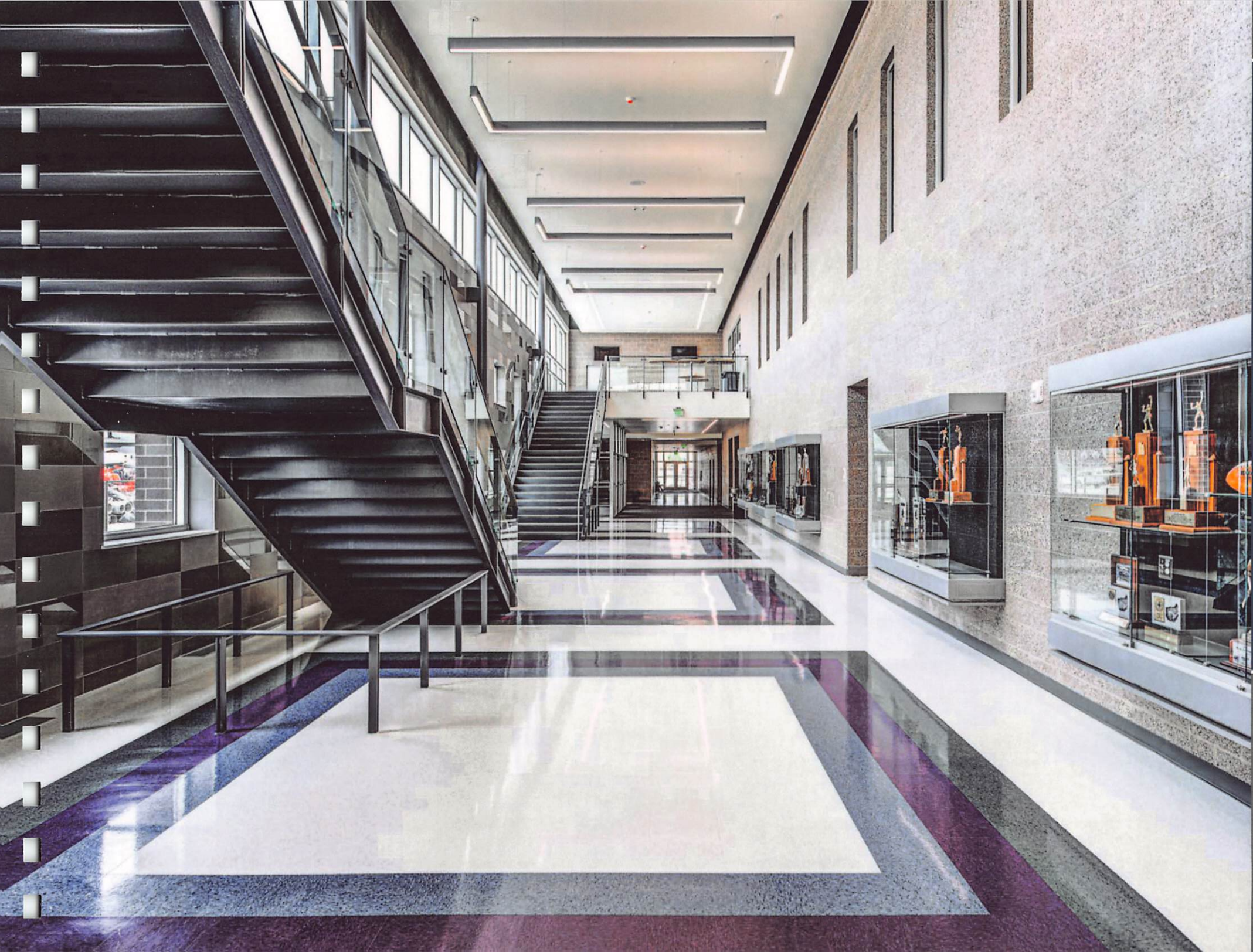

UTAH CONSTRUCTION & DESIGN

2021 MOST OUTSTANDING PROJECT

K-12 EDUCATION

LEHI HIGH SCHOOL ACTIVE-SITE REBUILD | LEHI, UTAH



SECTION 3 | REFERENCES

THIS IS WHAT OVER TWO DECADES OF FOCUS, INTEGRITY, AND COMMITMENT LOOKS LIKE... +215 EDUCATION PROJECTS COMPLETED SINCE 2001

NEW HIGH SCHOOLS | REPLACEMENTS | ADDITIONS

Spanish Fork HS REBUILD	Springville HS Addition
Timpview HS REBUILD	Pineview HS Renovations
Hillcrest HS REBUILD	Snow Canyon HS Renovation
Lehi HS REBUILD	Cottonwood HS Upgrades
NEW Mountain Ridge HS	Pl. Grove HS Addition
NEW Provo HS	Hurricane HS Upgrades
NEW Union HS	Spanish Fork HS Perf. Arts
Richfield HS REBUILD	Springville HS Perf. Arts
Altamont HS REBUILD	Payson HS Perf. Arts
Uintah HS REBUILD	Union HS Upgrades
Uintah HS Sports Complex	Payson HS Upgrades
Itineris Early College Prep HS	Morgan HS Athletic Facility
Landmark HS	Manila HS Addition/Remodel
Timpanogos HS Seminary	Manila HS Gymnasium
Payson HS Addition (2)	Hillcrest HS Addition/Remodel

NEW JUNIOR HIGH SCHOOLS | REPLACEMENTS | ADDITIONS

Maple Grove Middle School	Hurricane MS A/C
Valley View Middle School	Tonaquint MS A/C
Lakeridge Jr. High Remodel	Pineview MS Renovations
Lakeridge Jr. High Seminary	Vernal MS Remodel
Orem Jr. HS Addition	Am. Fork Jr. HS Addition
Helper Jr. HS Remodel	Spanish Fork Jr. HS Remodel Payson
Westridge MS Remodel	Athletic Remodel
Spanish Fork MS Addition	Brockbank Renovation
Snow Canyon MS Renovation Desert	Roosevelt Jr. Addition
Hills MS Upgrades	West Lake Jr. Upgrades
Hurricane MS Upgrades	

HIGHER EDUCATION FACILITIES

BYU SWKT Penthouse	BYU Ellsworth Building
BYU Martin Bldg Renovation	BYU Richards Bldg Addition
BYU Smoot Bldg Remodel	BYU Marching Band Facilities
BYU Press Bldg. Dock	BYU Helaman Halls Bldg. 9
BYU LDS Motion Pict Studio	BYU Harris Fine Arts Remodel
BYU MPS Bldg. Addition	Wet Storage Facility
BYU Snell Building Renov.	Provo Ameritech College
BYU Edwards Stadium Upgrade	Snow College Campus B4
BYU Brimhall Remodel	Rocky Mountain University
BYU Marriott Ctr Seismic	Windriver School

ELEMENTARY SCHOOLS | REPLACEMENTS | ADDITIONS

Silver Lake Elementary #152	Sierra Bonita Elementary	Arrowhead Upgrades
Vineyard Elementary #206	Ashley Elementary	Red Mountain Upgrades
Cascade Elementary REBUILD	Oak Hollow Renovation	Riverside Upgrades
Lehi Elementary #113	Westmore Elementary REBUILD	Bloomington Renovations
Liberty Hills Elementary	Cherry Hill Elementary REBUILD	Washington Addition
Brookhaven Elementary	East Elementary Addition	Horizon Upgrades
Belmont Elementary	West Lehi Elementary	Greenwood Elem. Addition
Springside Elementary	Sunnyside Elementary	Washington Renovation
Apple Valley Elementary	Maple Ridge Elementary	Bloomington Renovation
Rock Canyon Elementary RE-BUILD	Meadowbrook Elementary	Coral Cliffs Renovation
Sunset View Elementary REBUILD	Sunset Elementary	Washington Renovation
Midvale Elementary	Brookside Elem Addition	Heritage Elem. Upgrades
Maple Ridge Elementary	Salem Elementary Addition	Nebo View Remodel
Duchesne Elementary REBUILD	Mona Elementary Remodel	Meadow Elem. Addition
Centennial Elementary	Hillsdale Addition	Syracuse Addition/Remodel
River Rock Elementary	Desert Hills Upgrades	Oak Hollow Renovation
Dry Creek Elementary	Sunset Upgrades	Alpine Seismic Upgrade
Foothills Elementary REBUILD	Dixie Downs Renovation	Sego Lily Seismic Upgrade
Naples Elementary	Washington Elem Upgrades	Highbury Elem. Renovation
East Carbon Elementary REBUILD	Arrowhead Elem Upgrades	Red Cliffs Stabilization
Red Cliffs Elementary	Coral Canyon Upgrades	Centennial Elem. Upgrades
Desert Hills Upgrades	Diamond Valley Upgrades	Zenos Black Voc. Bldg.
Brookside Elementary	Dixie Downs Upgrades	King's Peak Elem. Upgrades
Eagle View Elementary REBUILD	Horizon Upgrades	Altamont Elem. Upgrades
	Little Valley Upgrades	

SCHOOL SPORTS FACILITIES

Duchesne District Indoor Athletic Facility
Pleasant Grove HS Fieldhouse
Wasatch SD Aquatic Center
Uintah HS Football Complex
Uintah HS Indoor Athletic & Track Facility
Morgan HS Indoor Athletic & Track Facility
Duchesne HS Football Field
Uintah HS Baseball Grandstand & Press Box
Hillcrest Soccer Fields
Union HS Baseball Complex
Hurricane HS Football Field/Track & Bleachers

ADDITIONAL SCHOOL DISTRICT PROJECTS

Lyman SD Admin. Bldg, Lyman, Wyoming
Alpine SD Transportation Hub, Saratoga Springs
Nebo School District Office, Spanish Fork
Morgan School District Bus Transportation Facility
Alpine Transition & Education Center
Carbon County School District Offices

K-12 EDUCATION REFERENCE PROJECTS



01

01. HILLCREST HIGH SCHOOL

CANYONS SCHOOL DISTRICT

Completed April 2022
 On-Site Active Site Replacement 412,000 sf
 Rick Conger, Director of Facilities (801) 826-5100 rick.conger@canyonsdistrict.org



02

02. SPRINGSIDE ELEMENTARY

ALPINE SCHOOL DISTRICT *7-MONTH OWNER REQUESTED ACCELERATED SCHEDULE*

Completed August 2016
 New Construction 80,000 sf
 Frank Pulley Jr., Director of Facilities Phone: (801) 610-8060 frankpulleyjr@alpinedistrict.org



03

03. MEADOWBROOK ELEMENTARY

NEBO SCHOOL DISTRICT

Completed July 2016
 New Construction 100,000 sf
 Matt Gledhill, Operations Director (801) 374-7400 matt.gledhill@nebo.edu



04

04. WASATCH AQUATIC CENTER

WASATCH COUNTY SCHOOL DISTRICT

Completed May 2017
 New Construction 37,000 sf
 Francis Harrison, WCSD Construction Manager (801) 420-3598 francis.harrison@wasatch.edu



05

05. NEW UNION HIGH SCHOOL

DUCHESNE COUNTY SCHOOL DISTRICT

Completed July 2018
 New Construction 333,000 sf
 David Brotherson, DCSD Superintendent (435) 503-2388 dbrotherson@dcsd.org

LETTERS OF REFERENCE



April 13, 2021

Re: Westland Construction Recommendation Letter

To Whom It May Concern:

PRINCIPALS

- Niels E. Valentiner, AIA
- Brent H. Tappels, AIA
- Jeanne Jackson, FAIA
- Derek T. Payne, AIA
- Vern Latham, AIA
- Jeffery L. Finegar, AIA
- David S. Cox, AIA
- Celestia H. Carson, AIA
- Alex Booth, AIA
- Nathan H. Leavitt, AIA
- Whitney M. Ward, AIA
- Philip M. Hackett, AIA

ASSOCIATE PRINCIPALS

- Jula Ojerda, AIA
- Mariko Vincenzo, NCIDQ
- Brianne Borsanage, AIA
- Dan Hugerman, AIA, CS
- Coreen Cozack, NCIDQ
- Michael Pfall, AIA
- Carlos Lujan, LEED AP

ASSOCIATES

- Karen M. Ferguson
- Todd Braun
- Brian Peterson
- Joseph Vothrovich
- Michael Fine
- Lori Lloyd, AIA
- Paula Gotay
- Lissa Linkem, NCIDQ
- Nancy McKendrick, NCIDQ
- Lorraine Bishop, AIA
- Cathy Sirest, AIA

CHIEF OPERATING OFFICER

Melissa Wood

CONTROLLER

Elizabeth Strucchi, DM

PRINCIPAL EMERITUS

- Steve Crane, FAIA
- Peter F. Burrows, AIA
- Sean Oryon, AIA
- Boyd McAllister, AIA

As a Principal/Owner at VCBO Architecture, LLC, I have had the opportunity to oversee teams responsible for delivering highly complex and challenging projects. This experience has allowed me the opportunity to interface with numerous clients and local, regional, and international contractors. The success of each of these projects hinges on the relationship between the Owner, Architect, and Contractor as we attempt to balance cost, scope, and quality in a manner consistent with the Owner's project expectations. When I think of successful project experiences, Westland Construction comes to mind. My experience working with Westland Construction on challenging projects with multiple complexities has more than exceeded my expectations.

Since 2011, VCBO has worked alongside Westland on over a dozen projects. Our collaborations have included a variety of unique facilities, ranging from healthcare to K-12. Many of our projects have required unique expertise and knowledge, particularly when it comes to longevity and durability. Along the way, Westland has repeatedly proven that they possess the experience necessary to take on complex projects.

In addition, Westland's team is exceptionally skilled at identifying construction issues as well as coming forward with possible improved solutions. Westland consistently demonstrates a positive problem-solving approach while maintaining strong and lasting team relationships. Additionally, they are always fair and reasonable regarding project changes and cost change orders. I find them to be honest and a good representative for the Owner related to subcontractor changes.

In addition to the reasons listed above, I feel that Westland Construction is an excellent addition to any team for the following reasons: first, they are invested and have the capacity to undertake the challenges of working on a team; second, they have the ability to organize and solve problems in a creative manner; and third, they have the capability to rethink, innovate, and suggest new alternative solutions to any given construction challenge.

Westland has been an excellent teaming partner throughout the construction process and has often surpassed the design team and Owner's expectations. For these reasons, I would without hesitation give them a high recommendation.

Respectfully,

Vern Latham AIA, Partner
 VCBO Architecture, LLC
 524 South 600 East, Salt Lake City, UT 84102
 (801) 575-8800
 vlatham@vcbo.com



101 East 200 North • Heber City, UT 84032
 (435) 654-0280 • FAX (435) 654-4714
 www.wasatch.edu

BOARD OF EDUCATION

Ann Harner
 President

May 10, 2017

Blank Baird
 Vice-President

To Whom It May Concern:

Mark Davis
 Board Member

Wasatch School District awarded the construction contract for our new Aquatic Center to Westland Construction in the spring of 2016. The facility is nearly complete and will be ready for occupancy soon.

Tom Hansen
 Board Member

Debbie Jones
 Board Member

Westland Construction has been excellent to work with on this project. Aquatic Centers are complex and challenging to construct due to the large amount of underground work that has to be done. Westland has paid extra attention to every detail on this project. We experienced a very snowy and cold winter which makes it difficult to stay on schedule. Westland has worked tirelessly to finish our Aquatic Center on time. With just a couple of weeks to go, we expect occupancy will take place by the date specified in the contract. Westland is very good at staying within budget. We expect the total of all change orders on our project will be less than 1% of the contract amount. That is an excellent record considering some of these change orders have been owner requested additions.

SUPERINTENDENT

Paul A. Sweet

BUSINESS ADMINISTRATOR

Keith Johnson

It is without hesitation that I recommend Westland Construction for your construction project. Please contact me if you would like to further discuss Wasatch School District's experience with Westland Construction.

Cordially,

Francis Harrison
 Construction Manager
 Wasatch County School District
 801-420-3598

LETTERS OF REFERENCE



490 NORTH STATE STREET, LINDON, UT 84042
(801) 610-8060 FAX (801) 785-8782

FRANK P. PULLEY
DIRECTOR OF PHYSICAL FACILITIES

February 10, 2021

To Whom It May Concern:

On behalf of Alpine School District, I am happy to provide a letter of recommendation for Westland Construction.

As Utah's largest school district, we are constantly planning for and addressing student growth. This effort requires the help of an experienced and trusted construction management partner, and we have been grateful for the opportunity we've had to work with Westland Construction.

Since 2010, Alpine School District has partnered with Westland on more than 30 different K-12 projects, from smaller additions to multi-phase replacements, worth more than \$300M. This longstanding relationship has helped us navigate the changing needs of our growing school district.

Over the past decade, we've gotten to know the team at Westland well. Their commitment and dedication to our projects has continually earned our trust and repeated business. We know we can count on them to complete our projects on time and within budget.

We consider Westland Construction to be leaders in their industry, and we highly recommend them to those who are seeking a skilled and experienced education construction partner.

Sincerely,

Frank Pulley
Director of Physical Facilities
Alpine School District
Phone: (801) 610-8060
frankpulleyjr@alpinedistrict.org

Samuel Y. Jarman, Superintendent
Dr. Mark Clement, President, Sarah Beeson, Vice-President
Stacy Bateman, Amber Bonner, Sara Hacken, Julie King, Ada Wilson



BOARD OF EDUCATION
Shannon Acor
Rick B. Ainge
Scott Card
Christine Riley

Lisa Rowley
John S. Taylor
Shauna Warnick

SUPERINTENDENT
Richard C. Nielsen
BUSINESS ADMINISTRATOR
Michael Harrison

May 6, 2021

To Whom It May Concern:

It is my pleasure to provide a letter of recommendation for Westland Construction on behalf of Nebo School District.

As Utah's fastest-growing school district, our team has been involved in numerous building projects over the years in order to address the evolving needs of our students, staff, and community. Since 2003, Nebo School District has joined with Westland on more than 20 significant K-12 projects worth over \$200M.

Westland Construction is an outstanding Construction Management partner. Their team is easy to work with and has done a fantastic job of helping us build the highest-quality education facilities. They understand our needs and have continually demonstrated their commitment to meeting our budget and schedule. We appreciate their professionalism and cooperation when working with a variety of district stakeholders.

When challenges present themselves, it's been a great benefit to have Westland in our corner. They provide innovative and budget-conscious solutions and have worked diligently to help us achieve our goals. In addition, Westland's executive leadership has always been involved in our projects, regardless of the size.

Westland Construction is experienced, knowledgeable, and fair. Their contributions have proven to be invaluable to the success of our many school projects. We look forward to working with them more in the future.

Sincerely,

Matt Gledhill
Operations Director
Nebo School District
Phone: (801) 354-7433
matt.gledhill@nebo.edu

OFFICE OF ADMINISTRATION
350 S Main, Spanish Fork, UT 84660

PHONE
(801) 354-7400

FAX
801-798-4010

WEB
www.nebo.edu





SECTION 4 | CHANGE ORDER EXAMPLES

As requested, these examples reflect maintaining budget and schedule These are CM/GC Prequalification & Bid, similar to the New WCSD High School project



MEADOWBROOK ELEMENTARY SCHOOL

Nebo School District

CM/GC BID - Finished 2 months ahead of schedule

50% Design Estimate	\$ 17,580,000
GMP Costs	\$ 17,366,485
Original Owner Contingency Fund	\$ 360,000
Contingency Draws	\$ 237,464
Contractor Initiated *	\$ 45,000
Owner Initiated	\$ 192,464
Remaining Funds credited back to District	\$ 122,536
Owner AIA Contract Change Order Total **	\$ 555,048
Final Completion Cost	\$ 17,798,998

*Note: Contractor Initiated COs were a result of Owner-Request for more site security for theft prevention

**Note: Owner added off-site road improvements costs that were negotiated with the city. Owner also added additional kitchen equipment to go from a warming kitchen to full cooking kitchen.

SCHEDULE

Start of Construction	2/25/2016
Substantial Completion	5/24/2016
Time Extensions	None
Final Completion	6/15/2016



SPRINGSIDE ELEMENTARY SCHOOL

Alpine School District

CM/GC BID - 7 month completion of 80,000 sf school

50% Design Estimate	\$ 18,592,000
GMP Costs	\$ 18,325,061
Original Owner Contingency Fund	\$ 737,280
Contingency Draws	\$ 156,956
Contractor Initiated	\$ 2,119
Owner Initiated	\$ 154,837
Remaining Funds credited back to District	\$ 580,324
Owner AIA Contract Change Order Total*	\$ 0,000
Final Completion Cost	\$ 17,744,737

SCHEDULE

Start of Construction	1/13/2016
Substantial Completion	7/23/2016
Time Extensions	None
Final Completion	8/12/2016

CHANGE ORDER EXAMPLES

As requested, these examples reflect maintaining budget and schedule on Low Bid projects



SUNSET VIEW ELEMENTARY SCHOOL REPLACEMENT

Provo School District

LOW BID

	Low Bid Project
50% Design Estimate	
Contracted Costs	\$ 12,533,300
Original Owner Contingency Fund	\$ 385,447
Contingency Draws	\$ 385,447
Contractor Initiated *	\$ 26,290
Owner Initiated	\$ 359,156
Remaining Funds credited back to District	\$ 0
Owner AIA Contract Change Order Total*	\$ 287,131
Final Completion Cost	\$ 12,820,431

*Note: Contractor Initiated COs decided upon post-bid. District added technology infrastructure that they had originally determined to perform in-house.

SCHEDULE

Start of Construction	6/17/2015
Substantial Completion	9/15/2016
Time Extensions*	9/15 - 11/18
Final Completion	11/18/2016

*Note: Owner approved extension for changes made to existing remodel



ROCK CANYON ELEMENTARY SCHOOL REPLACEMENT

Provo School District

LOW BID

	Low Bid Project
50% Design Estimate	
Contracted Costs	\$ 13,106,700
Original Owner Contingency Fund	\$ 372,267
Contingency Draws	\$ 369,030
Contractor Initiated	\$ 0
Owner Initiated	\$ 369,030
Remaining Funds credited back to District	\$ 3,236
Owner AIA Contract Change Order Total*	\$ 290,958
Final Completion Cost	\$ 13,394,422

*Note: Change order was decided upon post-bid. District added technology infrastructure that they had originally determined to perform in-house.

SCHEDULE

Start of Construction	6/17/2015
Substantial Completion	9/15/2016
Time Extensions	9/15 - 11/18
Final Completion	11/18/2016

*Note: Owner approved extension for utility change



UTAH CONSTRUCTION & DESIGN

2019 MOST OUTSTANDING PROJECT

K-12 EDUCATION

MOUNTAIN RIDGE HIGH SCHOOL | HERRIMAN, UTAH



SECTION 5 | FINANCIAL STATEMENTS & BONDING

OUR FISCAL STABILITY IS YOUR ASSET

Westland is devoted to being financially prepared for any opportunity or challenge that is on the horizon. We are proud of the fact that we operate debt-free, and maintain substantial cash reserves.

Because of this fiscal philosophy, Westland Construction is able to deliver projects in excess of \$400,000,000 average per year.

Please refer to the separate, sealed envelope containing originals of the bid bond, and a copy of our **CONFIDENTIAL** Financial Statements.

Westland Construction is a privately-held company, *therefore, any submitted financial information is not for public release or viewing.*



FINANCIAL STATEMENTS & BONDING



August 02, 2022

Re: Westland Construction, Inc.

To Whom It May Concern:

Moreton & Company has been pleased to represent Westland Construction, Inc. to the surety community. With your selection of Westland Construction, you will be working with one of the finest contractors in the state of Utah. Westland Construction not only completes their projects within time and budget, there has never been a claim situation with their surety carrier.

- Arch Insurance Company is the surety for Westland Construction.
- Arch Insurance Company has and A.M Best rating of A+ XIII.
- Arch Insurance Company has extended surety credit to Westland of \$350,000,000 single and \$950,000,000 aggregate.

We would favorably consider a request from Westland Construction to provide the bid, performance and payment bonds that may be required for the above-captioned project. Such prequalification and approval would be conditioned upon acceptable underwriting considerations, such as: contract terms, bond forms, and a favorable review of current underwriting information at the time of the request for the bond(s).

This letter is not an assumption of liability, nor is it a bid bond or a performance bond. It is issued only as a bonding reference requested from us by our client.

If you have any additional questions, of a non-confidential matter, please feel free to contact me at (801) 531-1234.

Sincerely,

Philip S. Walter, Senior Vice-President





SECTION 6 | LICENSING & INSURANCE

ACORD		CERTIFICATE OF LIABILITY INSURANCE		DATE (MMDDYYYY) 3/22/2022			
THIS CERTIFICATE IS ISSUED AS A MATTER OF INFORMATION ONLY AND CONFERS NO RIGHTS UPON THE CERTIFICATE HOLDER. THIS CERTIFICATE DOES NOT AFFIRMATIVELY OR NEGATIVELY AMEND, EXTEND OR ALTER THE COVERAGE AFFORDED BY THE POLICIES BELOW. THIS CERTIFICATE OF INSURANCE DOES NOT CONSTITUTE A CONTRACT BETWEEN THE ISSUING INSURER(S), AUTHORIZED REPRESENTATIVE OR PRODUCER, AND THE CERTIFICATE HOLDER.							
IMPORTANT: If the certificate holder is an ADDITIONAL INSURED, the policy(ies) must have ADDITIONAL INSURED provisions or be endorsed. If SUBROGATION IS WAIVED, subject to the terms and conditions of the policy, certain policies may require an endorsement. A statement on this certificate does not confer rights to the certificate holder in lieu of such endorsement(s).							
PRODUCER CSOZ, LLC 132 South State Street Salt Lake City UT 84111	CONTACT NAME: Emma Allen PHONE (A/C, No. Ext): 612-349-2436 FAX (A/C, No.): E-MAIL Address: eallen@csdz.com						
INSURED Westland Construction, Inc. 1411 West 1250 South Suite 200 Orem UT 84058	INSURER(S) AFFORDING COVERAGE		NAIC #				
	INSURER A: Zurich American Insurance Company		16535				
	INSURER B: Travelers Property Casualty Co. America		25674				
	INSURER C: Hanover Insurance Company		22292				
	INSURER D: Hanover Insurance Group		22292				
	INSURER E:						
	INSURER F:						
COVERAGES		CERTIFICATE NUMBER: 1219042031	REVISION NUMBER:				
THIS IS TO CERTIFY THAT THE POLICIES OF INSURANCE LISTED BELOW HAVE BEEN ISSUED TO THE INSURED NAMED ABOVE FOR THE POLICY PERIOD INDICATED. NOTWITHSTANDING ANY REQUIREMENT, TERM OR CONDITION OF ANY CONTRACT OR OTHER DOCUMENT WITH RESPECT TO WHICH THIS CERTIFICATE MAY BE ISSUED OR MAY PERTAIN, THE INSURANCE AFFORDED BY THE POLICIES DESCRIBED HEREIN IS SUBJECT TO ALL THE TERMS, EXCLUSIONS AND CONDITIONS OF SUCH POLICIES. LIMITS SHOWN MAY HAVE BEEN REDUCED BY PAID CLAIMS.							
INSR LTR	TYPE OF INSURANCE	ADDITIONAL INSURED	POLICY NUMBER	POLICY EFF. DATE (MMDDYYYY)	POLICY EXP. DATE (MMDDYYYY)	LIMITS	
A	COMMERCIAL GENERAL LIABILITY <input type="checkbox"/> CLAIMS-MADE <input checked="" type="checkbox"/> OCCUR <input type="checkbox"/> Contr Liab Per <input checked="" type="checkbox"/> Policy Form XCU GEN'L AGGREGATE LIMIT APPLIES PER: <input type="checkbox"/> POLICY <input checked="" type="checkbox"/> PERCENT <input type="checkbox"/> LOC. <input type="checkbox"/> OTHER	Y	Y	01060905106	4/1/2022	4/1/2023	EACH OCCURRENCE \$1,000,000 DAMAGE TO RENTED PREMISES (EA occurrence) \$300,000 MED EXP (Any one person) \$10,000 PERSONAL & ADV INJURY \$1,000,000 GENERAL AGGREGATE \$2,000,000 PRODUCTS - COMP/OP AGG \$2,000,000 \$
D	AUTOMOBILE LIABILITY <input checked="" type="checkbox"/> ANY AUTO <input type="checkbox"/> OWNED AUTOS ONLY <input type="checkbox"/> SCHEDULED AUTOS ONLY <input type="checkbox"/> HIRED AUTOS ONLY <input type="checkbox"/> NON-OWNED AUTOS ONLY	Y	Y	AWA489260	4/1/2022	4/1/2023	COMBINED SINGLE LIMIT (EA accident) \$1,000,000 BODILY INJURY (Per person) \$ BODILY INJURY (Per accident) \$ PROPERTY DAMAGE (Per accident) \$ \$
B	UMBRELLA LIAB <input checked="" type="checkbox"/> EXCESS LIAB <input type="checkbox"/> DEED <input type="checkbox"/> RETENTION \$ <input checked="" type="checkbox"/> OCCUR <input type="checkbox"/> CLAIMS-MADE			ZUP15T35380	4/1/2022	4/1/2023	EACH OCCURRENCE \$15,000,000 AGGREGATE \$15,000,000 \$
A	WORKERS COMPENSATION AND EMPLOYERS' LIABILITY ANY PROFIT TO EMPLOYEE EXCLUDED? (Mandatory in NH) If yes, describe under DESCRIPTION OF OPERATIONS below	Y/N	N/A	VC980905006	4/1/2022	4/1/2023	<input checked="" type="checkbox"/> PER STATUTE <input type="checkbox"/> OTHER E.L. EACH ACCIDENT \$1,000,000 E.L. DISEASE - EA EMPLOYEE \$1,000,000 E.L. DISEASE - POLICY LIMIT \$1,000,000
C	Owned Eq. (Max per item) Leased/Hired Eq. Installation Floater			RH4A89094	4/1/2022	4/1/2023	Ded \$1,000 \$180,000 Ded \$1,000 \$250,000 Limit Ded \$1,000 \$400,000
CERTIFICATE HOLDER	CANCELLATION						
Proof of Insurance	SHOULD ANY OF THE ABOVE DESCRIBED POLICIES BE CANCELLED BEFORE THE EXPIRATION DATE THEREOF, NOTICE WILL BE DELIVERED IN ACCORDANCE WITH THE POLICY PROVISIONS.						
	AUTHORIZED REPRESENTATIVE 						

STATE OF UTAH	
DEPARTMENT OF COMMERCE	
DIVISION OF OCCUPATIONAL & PROFESSIONAL LICENSING	
ACTIVE LICENSE	
EFFECTIVE DATE:	11/30/2015
EXPIRATION DATE:	11/30/2023
ISSUED TO:	WESTLAND CONSTRUCTION, INC. 1411 W 1250 S STE 200 OREM UT 84058
REFERENCE NUMBER(S), CLASSIFICATION(S) & DETAIL(S)	
5366682-5501	Contractor With LRF DBAs: None Associated
B100	

CERTIFICATE OF EXISTENCE

Registration Number: 5366682-0142
 Business Name: WESTLAND CONSTRUCTION, INC.
 Registered Date: August 01, 2003
 Entity Type: Corporation - Domestic - Profit
 Current Status: Good Standing

The Division of Corporations and Commercial Code of the State of Utah, custodian of the records of business registrations, certifies that the business entity on this certificate is authorized to transact business and was duly registered under the laws of the State of Utah. The Division also certifies that this entity has paid all fees and penalties owed to this state; its most recent annual report has been filed by the Division (unless Delinquent); and, that Articles of Dissolution have not been filed.



Kathy Berg

Kathy Berg
 Director
 Division of Corporations and Commercial Code



UTAH CONSTRUCTION & DESIGN

2018 MOST OUTSTANDING PROJECT

COMMUNITY IMPACT

UNION HIGH SCHOOL | ROOSEVELT, UTAH

UNION HIGH SCHOOL
850 EAST LAGOON ST



SECTION 7 | DISPUTE RESOLUTION

December 01, 2022

Selection Committee | Wasatch County School District
101 East 200 North, Heber City, UT

RE: New High School - Heber Utah

Dear Committee:

Please accept this letter as certification that neither Westland Construction, Inc., nor their principals are presently debarred, suspended, proposed for debarment, declared ineligible, or voluntarily excluded from soliciting work by any governmental department or agency. Additionally, neither Westland Construction, Inc., nor their principals have been terminated during the performance of a contract or withdrew from a contract to avoid termination.

Since its inception, Westland Construction has never failed in the completion of a project or fulfilling all of its contractual obligations with a project owner. There have been three personal injury cases over the years with one of the cases having Westland dismissed from the suit. All three involved insurance issues and all cases were successfully settled.

All other suits (Five in total) have evolved around issues regarding the performance of a subcontractor, and in one instance, the non-payment of contract amounts owed by the owner of the project to Westland Construction.

There is currently one case where Westland was named in a suit involving the non-payment by a subcontractor to a third party entity.

Except as stated above, all cases have been settled and there is currently no other litigation.

Respectfully,

Kyle A. Houghton, President





WESTLAND CONSTRUCTION CORPORATE HQ

1411 WEST 1250 SOUTH, SUITE 200
OREM, UTAH 84058 USA
PH: 801.374.6085

WESTLAND CONSTRUCTION SOUTHWEST

785 E VENTURE DRIVE
ST. GEORGE, UTAH 84790 USA
PH: 435.628.0187

WESTLAND CONSTRUCTION MEXICO

GRUPO IMPULSA
AV. VERACRUZ NO. 65 COL. CONDESA CDMX
TEL: +52 55-33-00-77-00

WESTLAND CONSTRUCTION SOUTH PACIFIC

L 1104 FANSHORE STREET
AUCKLAND 1010, NEW ZEALAND
PH: (7) +64 7-788 0054

WESTLAND CONSTRUCTION CANADA

5 RICHARD WAY SW, SUITE 300
CALGARY, ALBERTA T3E 7M8 CANADA
PH: 435.628.0187

WESTLAND CONSTRUCTION AFRICA

44A AVENUE DU LIVRE, GOMBE
KINSHASA. DRC AFRICA
PH: +243 82 977 1608



www.westlandconstruction.com

